

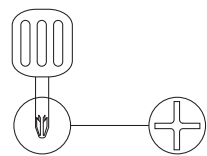

STAR PLANETARIUM

8+



AAA/LR03 x3

Batteries not included.

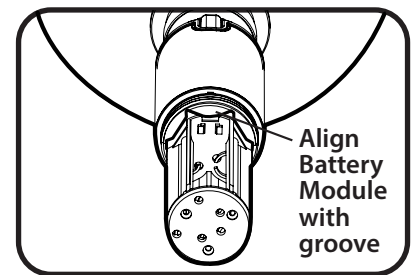
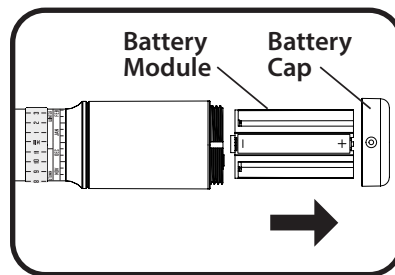
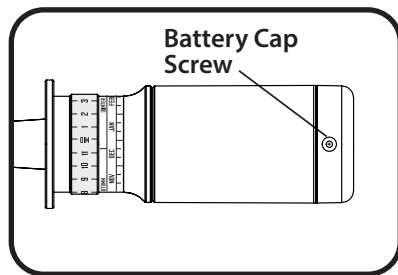

AAA/LR03 x3

Batteries not included.

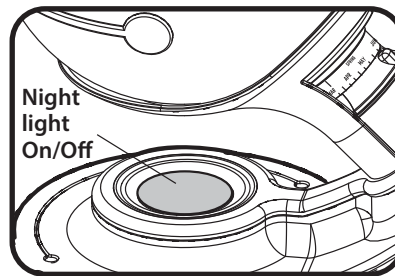
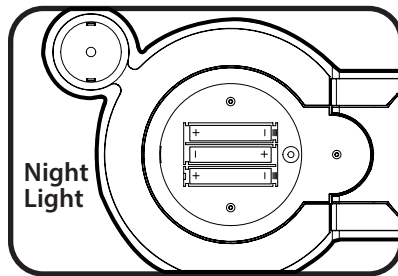

Operating Your Planetarium

1. Place planetarium on a table in the center of the room. A room with smooth, light-colored walls and ceiling works best. A room that is roughly square and no larger than 12 x 12 feet provides the best projection quality. Star Theater works best when it is located two to six feet from the projection surface.
2. Date selector is located on the light wand. To set your planetarium for the beginning of the audio tour, rotate light wand until "AUTUMN" lines up with pointer on the base. (The month and date settings and the time ring will be used after the audio tour to set your planetarium for a specific date and time of day.)
3. In a darkened room, turn on projection lamp. (Do not look directly at the Star Sphere while its light is on, or you will lose your darkness adaptation.)

Setting the Date and Time

You can set your planetarium to project the night sky for any date and hour. Here is how:

1. Setting the date: With projection lamp off, turn light wand until the month you want lines up with the pointer on date selector. Below the month, there are markings indicating the 1st, 10th and 20th of the month. Turn light wand to the left until the date you want lines up with the pointer. For example, if you want to project the night sky the way it is on July 4th, first select July, then turn further to the left, to just past the mark for the first day of the month.
2. Setting the time: Once you have selected the month and date, rotate the time ring—**without turning the light wand**—so that the time at which the sun sets lines up with the pointer. (The time at sunset can be found in the local newspaper or on the Internet.) Now turn the light wand to the exact time you want. (Note: The months and dates will change on the date selector as you select the time; once you've selected the date and set the time ring for sunset, the time selection function takes over.) You can set your planetarium to project the stars for any time of the night. You can even see what stars are up during the day, when they are not visible.

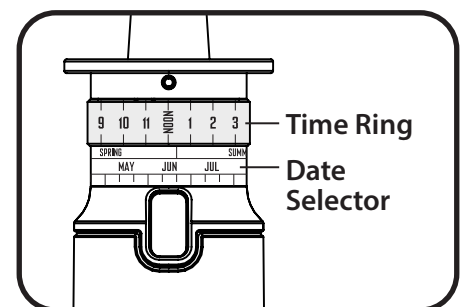

Download an exciting audio tour of the night sky and our Stellarium Astronomy Software at UncleMilton.com!



Web Code: STAT1143
Web Code: SPSAS1143

ITEM : 5107 Ever Wonder
Star Planetarium
SIZE : 8.5"W x 11"H
DATE : 20 APR 2017

*Care and Maintenance

Remove batteries when not in use for extended periods. Keep Star Sphere clean with a soft cloth and quality anti-static cleaner/polish. Never use abrasive cleaners.

Bulb replacement: Replacement bulbs are available at most electronics retailers. Halogen bulb, Voltage: 3.6 V, Current: 500 – 600 mA. Part No. LR00001.

1. Switch off the light wand and wait 10 minutes before changing the light bulb. Remove Star Sphere and light wand from base. **IMPORTANT**–Do not remove the Star Sphere when the light is switched on.
2. Push a paper clip into the small hole directly above the on/off button. At the same time, rotate light wand counterclockwise to Star Sphere. Remove it from Star Sphere.
3. Carefully pull old projection lamp out of tip of light wand.
4. **The Following step must be performed by an adult.**
Insert replacement bulb into tip of light wand. (Important: Be careful not to bend prongs of the bulb.) Switch light wand on to make sure bulb lights up, then switch it off.
5. Reinsert light wand into Star Sphere. Rotate light wand clockwise until it clicks into place. This is important for accurate date and time adjustments.
6. Place Star Sphere and light wand back into base.

* To be performed by an adult, as the above steps may cause harm to young children.

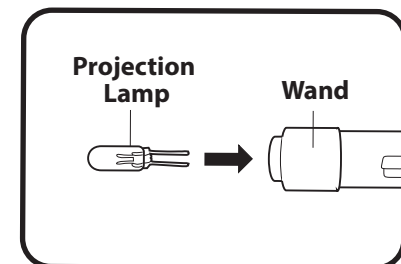
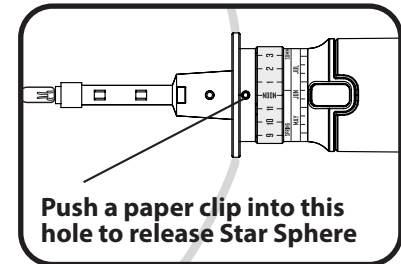

KEEP THESE INSTRUCTIONS FOR FUTURE REFERENCE — DO NOT DISCARD

Questions? Visit unclemilton.com

BATTERY SAFETY INFORMATION

- Only adults should install and replace batteries.
- Non-rechargeable batteries are not to be recharged.
- Rechargeable batteries are to be removed from the toy before being charged.
- Rechargeable batteries are only to be charged under adult supervision.
- Different types of batteries or new and used batteries are not to be mixed.
- Batteries are to be inserted with the correct polarity.
- Exhausted batteries are to be removed from the toy.
- The supply terminals are not to be short-circuited.
- Do not mix old and new batteries.
- Do not mix alkaline, standard (carbon-zinc) or rechargeable (nickel-cadmium) batteries.
- Do not dispose of batteries in fire. Battery may explode or leak.
- Batteries should be recycled or disposed of as per state and local guidelines.

Uncle Milton

© 2017 TBDUM. All rights reserved.
® and ™ designate U.S. trademarks of
Uncle Milton
P.O. Box 6281 Thousand Oaks, CA 91359 USA.
Printed in China. Product and colors may vary.



This product and its batteries must be disposed of separately at your local waste recycling center. Do not dispose them in your household waste bin.